User Manual



eMirror



Content

	Page
1. Joystick connection	3
2. System configuration	3
3. Options menu	4
3.1. Heating	4
3.2. Brightness	4
3.3. Reference lines	4
3.4. Change to class V	5
3.5. Change to class VI	5
4. Joystick shortcuts	5
5. "Settings" configuration	6
5.1. Reference lines configuration	9
6. Change log	10

1. Joystick connection

To use *eMirror* Joystick it's necessary to connect Joystick with a special cable. The first step is to power off system and disconnect power cable from *eMirror*. After that, connect the joystick with the special cable provided as indicated at below.

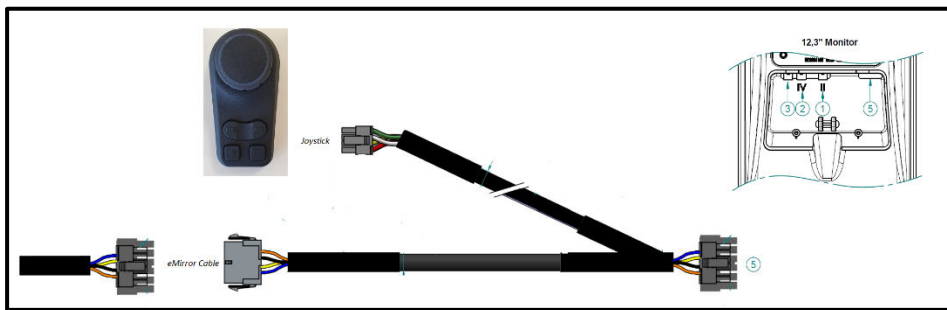

Figure 1.- Joystick Connection

2. System configuration

Power on the system and press on the Knob button until the icon bar appears on class II side of the display. This menu will disappear after a few seconds without any interaction with the joystick.

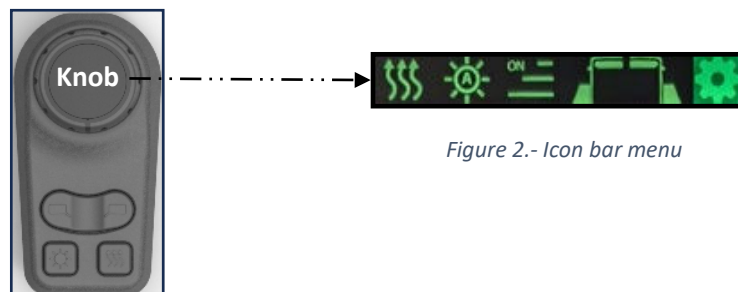

Figure 2.- Icon bar menu

eMirror configuration menu has different options available. Clicking on each icon sets the option to the desired value.

All the changes made on this menu, except "Settings" icon, will be temporary. After powering down the system, the changes will be restored to their defaults.

3. Options menu

3.1. Heating

It's possible to configure camera heating as it indicated below:



Heating automatic mode. When camera sensor temperature reaches inferior threshold eMirror enables camera heating until the camera reaches the superior threshold. [Default value]



Heating is off.



Heating is on. Forces the heater to heat until the camera reaches the upper threshold, avoiding overheating the unit.

3.2. Brightness

Monitor brightness can be configured as it indicated below:



Automatic brightness. Based on the ambient light, the system automatically configures the monitor brightness. [Default value]



Manual brightness. To set a specific brightness value, hold pressed this icon until a slider appears. You will be able to set the value rotating the knob and clicking on it to set the value.

3.3. Reference lines

Reference lines can be activated or deactivated as it indicated below. The default value depends on the configuration (see details in point 5.1):



Reference lines are on.



Reference lines are off.

3.4. Change to class V

System allows to show the class IV or V on monitor located at passenger's side as it indicated as following:



Monitor at passenger's side shows class V.



Monitor at passenger's side shows class IV. [Default value]

3.5. Change to class VI

System allows to show the class IV or VI on monitor located at driver's side as it indicated as following:



Monitor at driver's side shows class VI.



Monitor at driver's side shows class IV. [Default value]

4. Joystick shortcuts

Joystick has 4 buttons to access to configuration items on the menu directly:

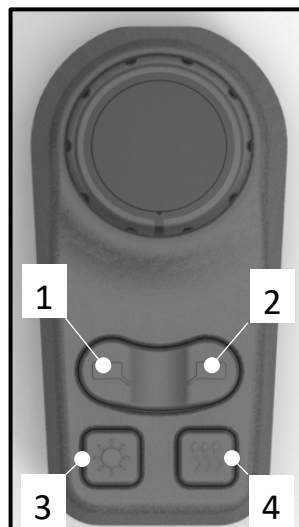

- 1.- Change to class VI
- 2.- Change to class V
- 3.- Brightness
- 4.- Heating

5. "Settings" menu

The following steps will lead you to configure different functions of the system.

Step 1

Press "Settings" icon on icon bar during 5s and release it. So, configuration menu will appear on class IV side of the display:

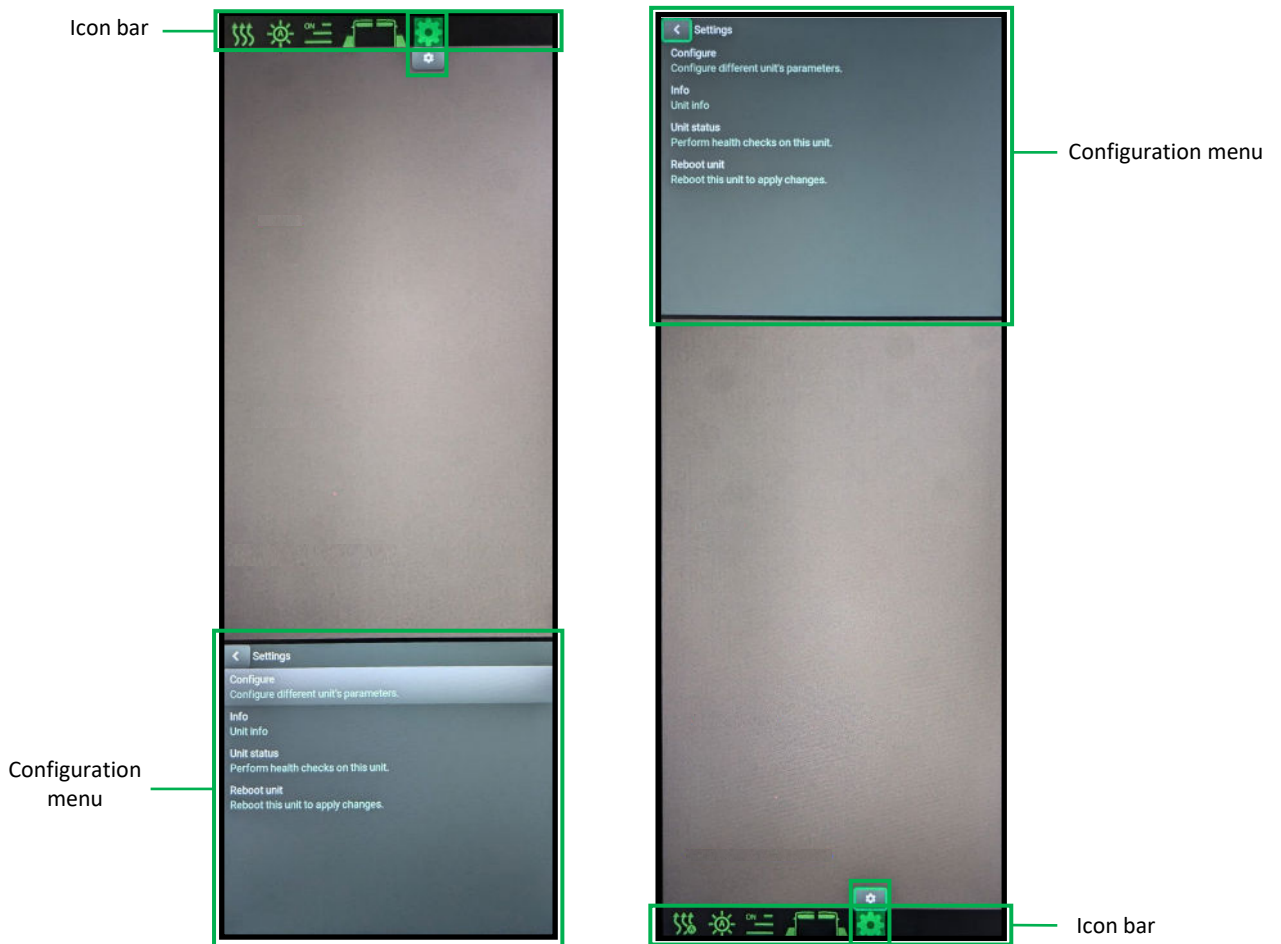

Figure 3.- Icon bar and Configuration menu

Step 2

Select “Configure” option (text highlighted in grey) and it will appear the different parameters of the system to change:

- **System Power-off Seconds:** Move the bar to define time desired. This is the time the unit will remain active after the KL-\$\$/Contact signal is removed.
- **Class II on Top Position:** Deactivate option to see class IV on the upper side, otherwise class II will be on the upper part of the display.
- **Reference lines:** Select this option to define reference lines position (see details in point 5.1).
- **Factory Settings:** Long press to reset to factory settings.
- **Save:** Active option to save system configuration permanently.

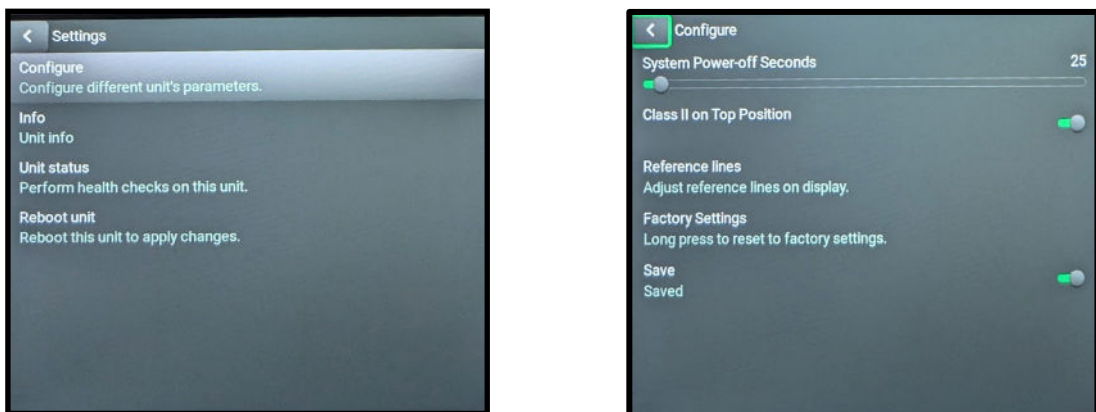

Figure 4- Configure menu

Step 3

Select “Info” option and it will appear the different information about the eMirror system as following:

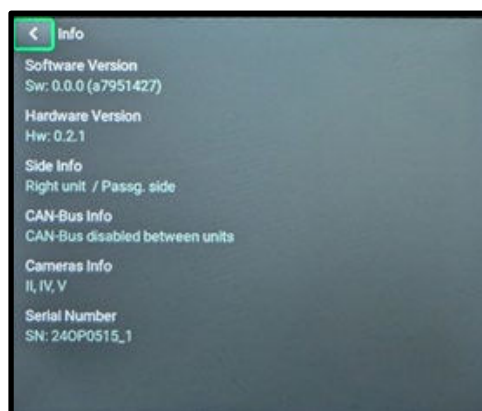

Figure 5.- Info menu

Step 4

Select “Unit status” option to check the hardware of the eMirror system:

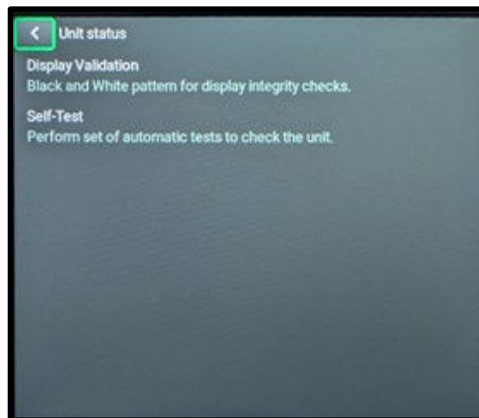

Figure 6.- Unit status menu

Step 4

Select “Reboot unit” option to see the most of changes done during system configuration:

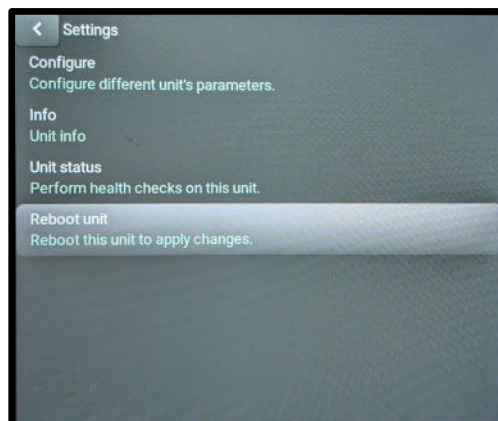

Figure 7.- Reboot unit menu

5.1. Reference lines configuration

- Once on “Configure” menu, select “Reference lines” option. This allows you to configure each of the three reference lines individually. Selecting each line item, you can set its position and width on display moving each of the sliders.
- Press “Save” option in main menu to save reference lines configuration.

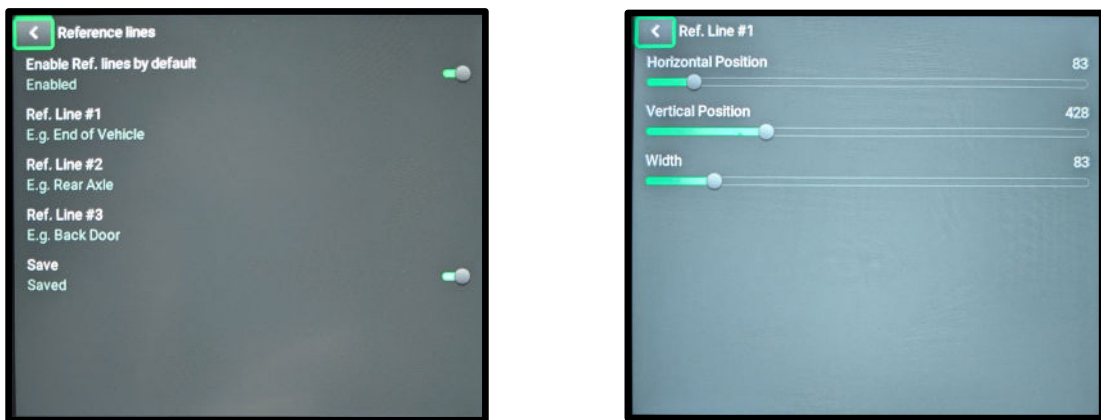

Figure 8.- Reference lines configuration menu

6. Change log

V 05/2023

- Document release

V11/2024

- Manual updated acc. to eMirror SW 2.0